

# NOTICE OF CITY MEASURE ELECTION

\_\_\_\_\_  
City of Newberg  
(Name of City)

Notice is hereby given that on \_\_\_\_\_  
May 20, 2014  
(Date of Election)

A measure election will be held in \_\_\_\_\_  
Yamhill County, Oregon.  
(Name of County or Counties)

The following is the true and complete ballot title of the measure to be submitted to the city's voters on this date:

**CAPTION** (10 Words)

Annexing 7.2 acres at 108 S. Springbrook Road into Newberg. (10 words)

**QUESTION** (20 Words)

Should Newberg annex approximately 7.2 acres located at 108 S. Springbrook Road?  
(12 words)

**SUMMARY** (175 Words)

This measure would annex one parcel to the City of Newberg. The parcel is adjacent to the current city limits on its east, south and west sides. The parcel would be zoned R-3 (high density residential), which matches the HDR (high density residential) comprehensive plan designation on the site. Annexation would also place a stream corridor overlay and airport overlay on the site, and withdraw the parcel from the Newberg Rural Fire Protection District.

The parcel is owned by the Estate of J.C. Walker, and the applicant is Springbrook Investments LLC. The R-3 zone would allow a variety of uses, including multifamily apartments. The stream corridor overlay would place some protections on the existing trees along the stream on the eastern portion of the property.

The Newberg City Council determined that the application met land use approval criteria. The Newberg Charter requires annexations to be approved by the electorate of the city. For more information, see Explanatory Statement. (158 words)

The following authorized city official hereby certifies the above ballot title is true and complete, which includes completion of the ballot title challenge process.

\_\_\_\_\_  
Signature of authorized city official (not required to be notarized)

\_\_\_\_\_  
Date signed

Norma Alley

Printed name of authorized city official

City Recorder

Title

**YAMHILL COUNTY, OREGON**  
**EXPLANATORY STATEMENT FOR YAMHILL COUNTY VOTER'S PAMPHLET**

Ballot Title Caption: Annexing 7.2 acres at 108 S. Springbrook Road into Newberg.

Word Count (500 words Max)   346  

---

**EFFECT OF PASSAGE:** If this measure passes, one parcel consisting of approximately 7.2 acres would be incorporated into the city limits of the City of Newberg. The parcel would be withdrawn from the Newberg Rural Fire Protection District.

**BACKGROUND:** This measure would annex one parcel located at 108 S. Springbrook Road to the City of Newberg. The parcel is adjacent to the current city limits on its east, south and west sides, and is within the Newberg Urban Growth Boundary. The parcel would be zoned R-3 (high density residential), with a stream corridor overlay on the eastern portion of the site. The proposed zoning matches the existing HDR (high density residential) Comprehensive Plan designation on the site.

The parcel is owned by the Estate of J.C. Walker, and the applicant is Springbrook Investments LLC. The R-3 zone would allow a variety of uses, including multifamily apartments. The stream corridor overlay would place some protections on the existing trees along the stream on the eastern portion of the property.

New development will be required to connect to sanitary sewer and water services upon development.

The Newberg City Council determined that the application has met the land use criteria for approval and that an adequate level of services is available or will be made available to serve the annexation area.

The Newberg Charter provides that annexations must be approved by a majority vote of the electorate of the city. The Council referred this matter to the May 20, 2014 election.

Information pertaining to this annexation measure, including a legal description, findings and additional maps, can be found on the City's website at <http://www.newbergoregon.gov>. Copies of the reports, minutes of the hearing, and a legal description are also available at the Newberg Planning and Building Department located at City Hall - 414 East First Street, Newberg, Oregon or (503) 537-1240.

**EFFECT OF FAILURE:** If this measure fails, the parcel would not be part of the City of Newberg but remain in Yamhill County outside the city limits, and the parcel would remain in the Newberg Rural Fire Protection District.

---

Statement submitted by:

Norma Alley

(Name of person responsible for the statement)

City Recorder

(Title of person responsible for the statement)

City of Newberg

(Governing Body person represents)

\_\_\_\_\_

(Signature of person responsible for the statement)

\_\_\_\_\_

(Date of Signature)

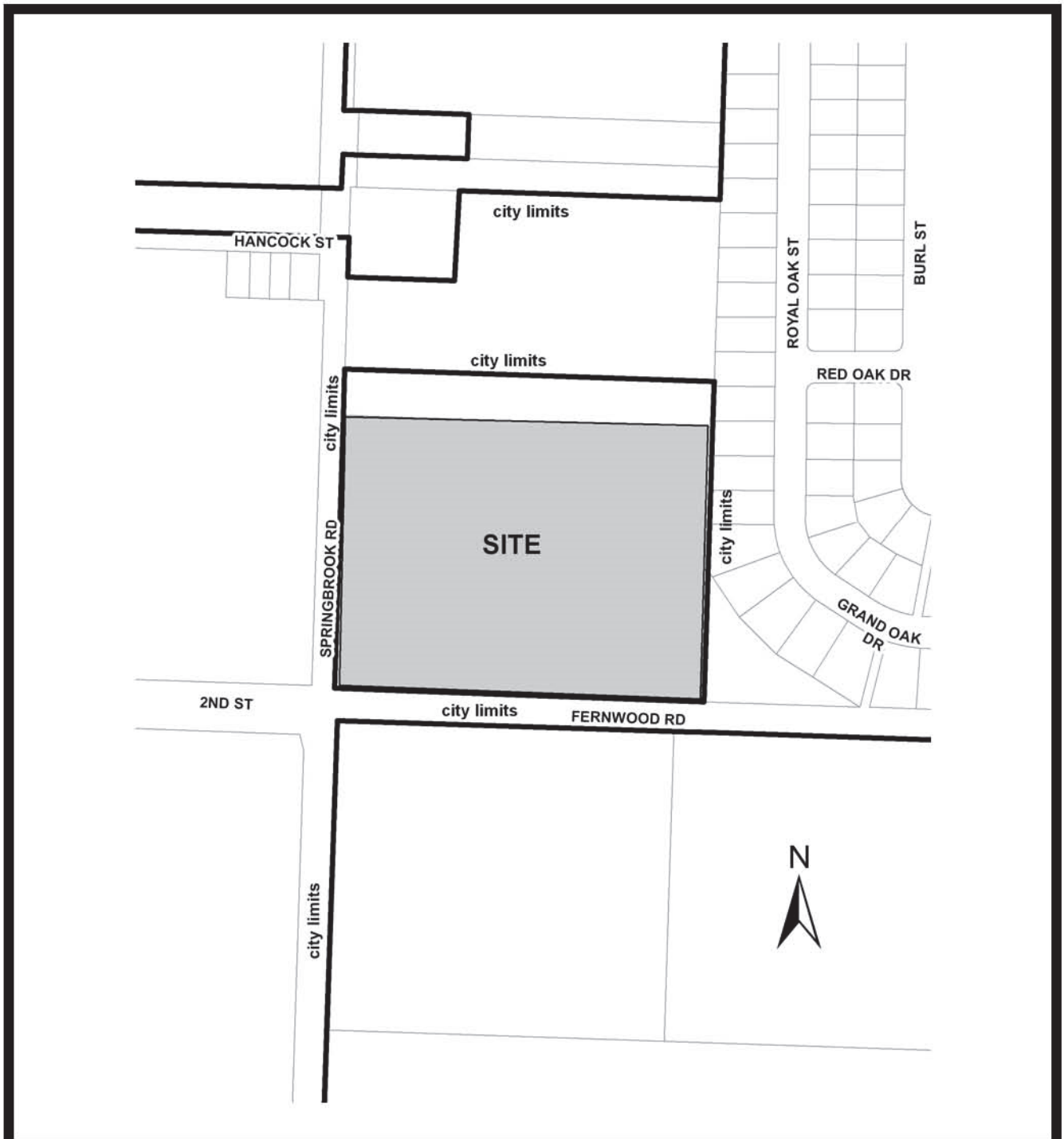

Description: Annexing 7.2 acres at 108 S. Springbrook Rd. into Newberg

File: ANX-13-001  
Date: May 20, 2014

SITE MAP

Tax Lot 3221-900  
Owner: Estate of J.C. Walker  
Applicant: Springbrook Investments LLC